

**PLANIMETRIA DIMOSTRATIVA**  
**PRESCRIZIONI D.P.R. n.503/96 - SCALA 1:500 - rev.01**

**LEGENDA :**

- . - Limite Comparto ST3\_P38 bis
-  Rotazione sedia a ruote di 360°

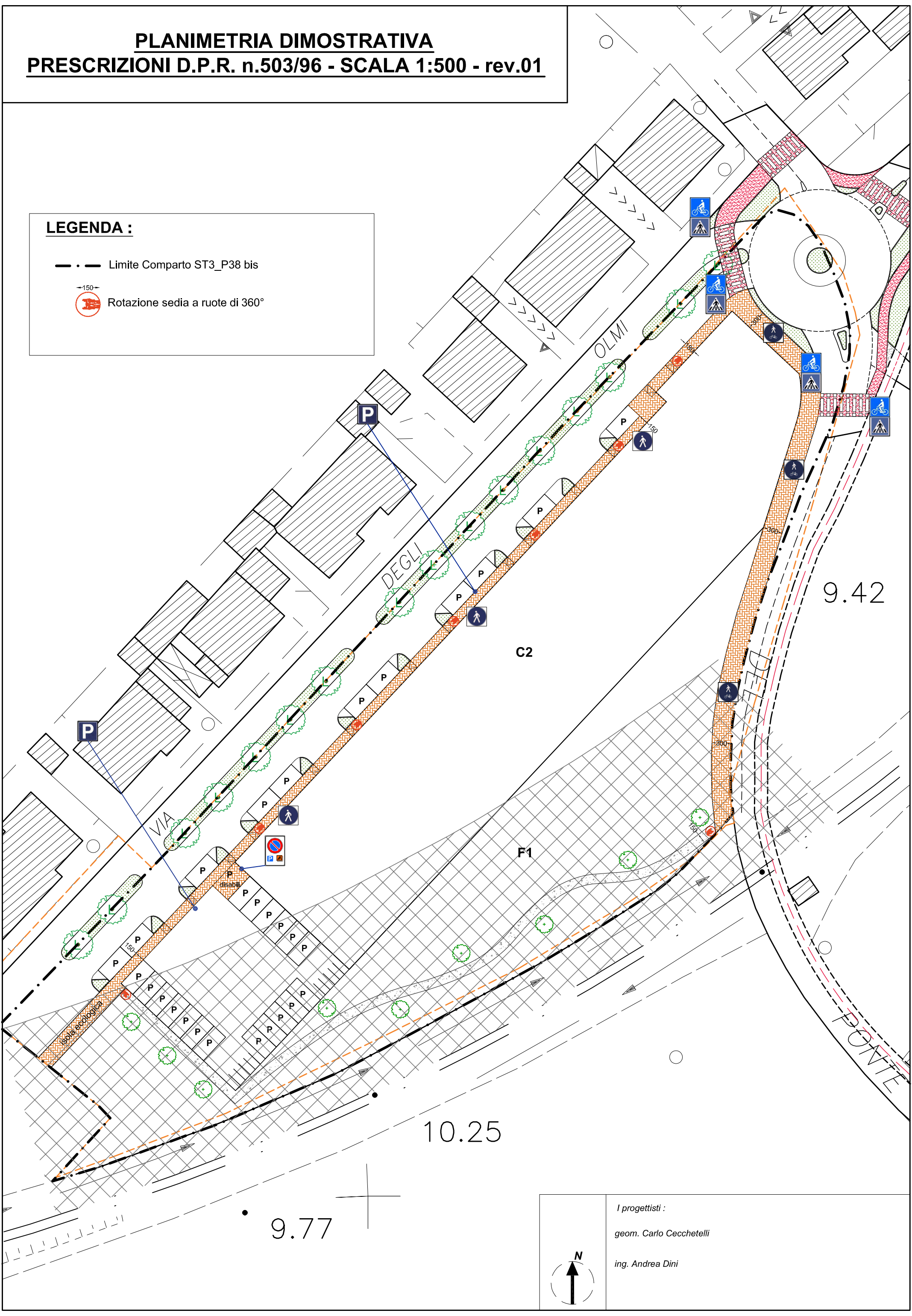

I progettisti :  
geom. Carlo Cecchetelli  
ing. Andrea Dini

